

## HPC PLATE CLAMP

- Simple construction and operation
- Automatic powerful clamping mechanism, clamps securely in proportion to the weight of the load.
- Clamps with force of more than twice the lifting load, yet leaves the materials free from unnecessary scars.
- Induction-hardened, special alloy steel cam.
- Main body made of high-tensile steel with a precision forged construction resistant to cracks
- With a locking spring
- Round swivel jaw to grip steel materials firmly
- Baked epoxy finish

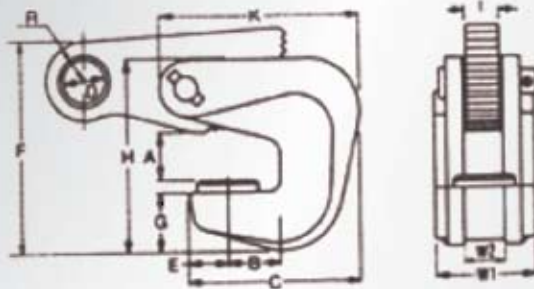

MODEL	LIFTING CAPACITY (Kg) Per Pair	JAW OPENING (mm)
HPC 075	750	0 - 25
HPC 150	1500	0 - 30
HPC 200	2000	0 - 45